

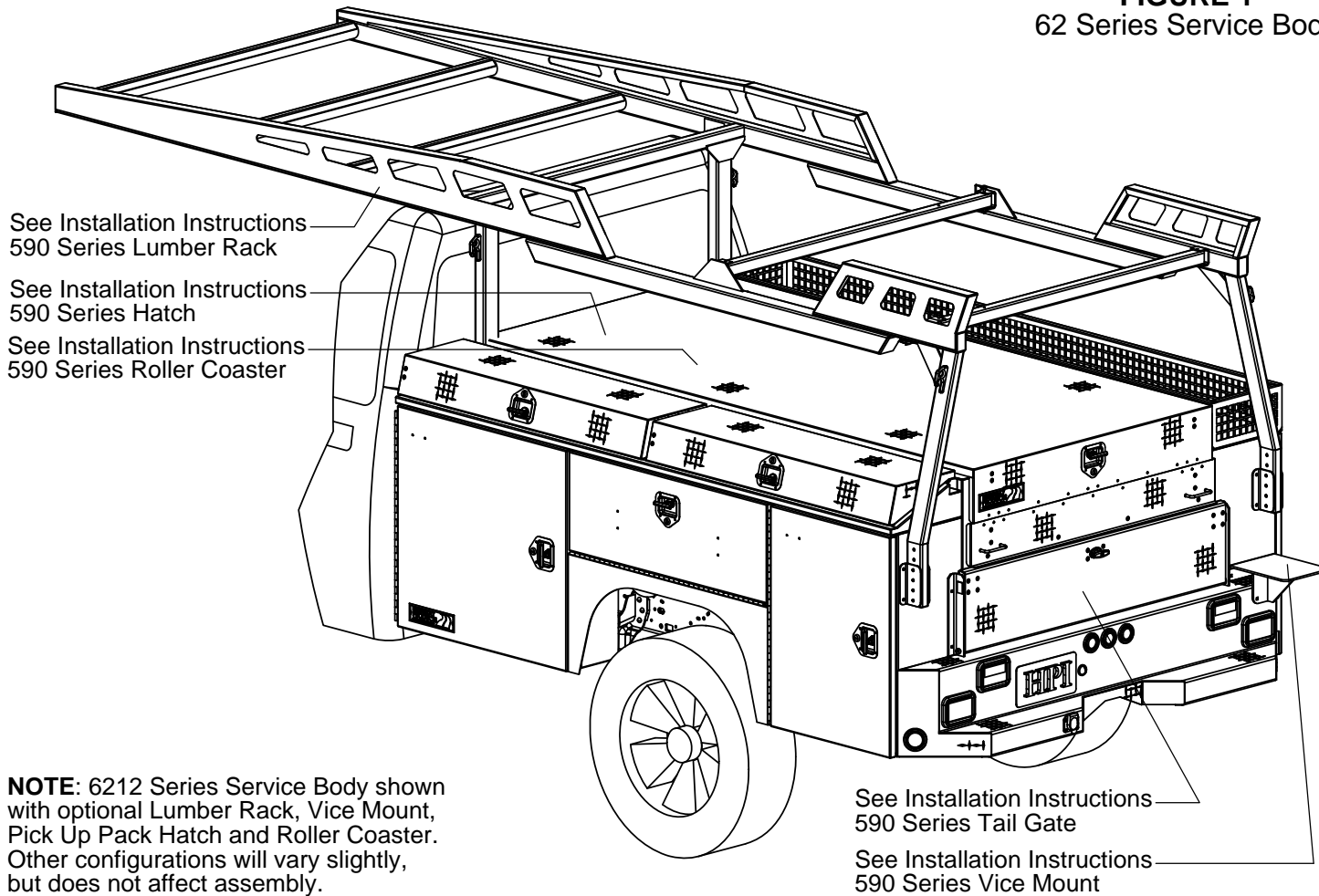

Installation Instructions: Service Body

FIGURE 1
62 Series Service Body



NOTE: 6212 Series Service Body shown with optional Lumber Rack, Vice Mount, Pick Up Pack Hatch and Roller Coaster. Other configurations will vary slightly, but does not affect assembly.

Attention Read all instructions and understand all warnings before installing or using this product.

	Danger of Electrocutation Disconnect battery before installation of product.	
--	--	--

	Danger of Explosion This product was not intended for the use of storing or transporting flammables, explosives, hazardous materials and hazardous waste such as but not limited to: gasoline, gun powder, dynamite, solvents or any pressurized tanks. Doing so could create hazardous conditions that can cause death, serious injury or property damage.	
--	---	--

Notes

- | | | |
|---|--|--|
| <ul style="list-style-type: none"> • Use safety glasses when using tools or working under vehicle. • Perform all work on dry level ground. • Insure vehicle's parking break is engaged and wheels are chocked. | <ul style="list-style-type: none"> • Due to the size and weight of products more than one person is required for lifting and installing of this product. • Do not over tighten hardware. | |
|---|--|--|

Tools Required

	Safety Glasses		Welding Equipment		Wire Crimping Set
	Drill		Various Clamps		Ratchet & Socket Set
	Drill Bit Set		Mallet & Hammer		Wrench Set
	Hole Saw Set		Tape Measure		Hand Srewdriver Set

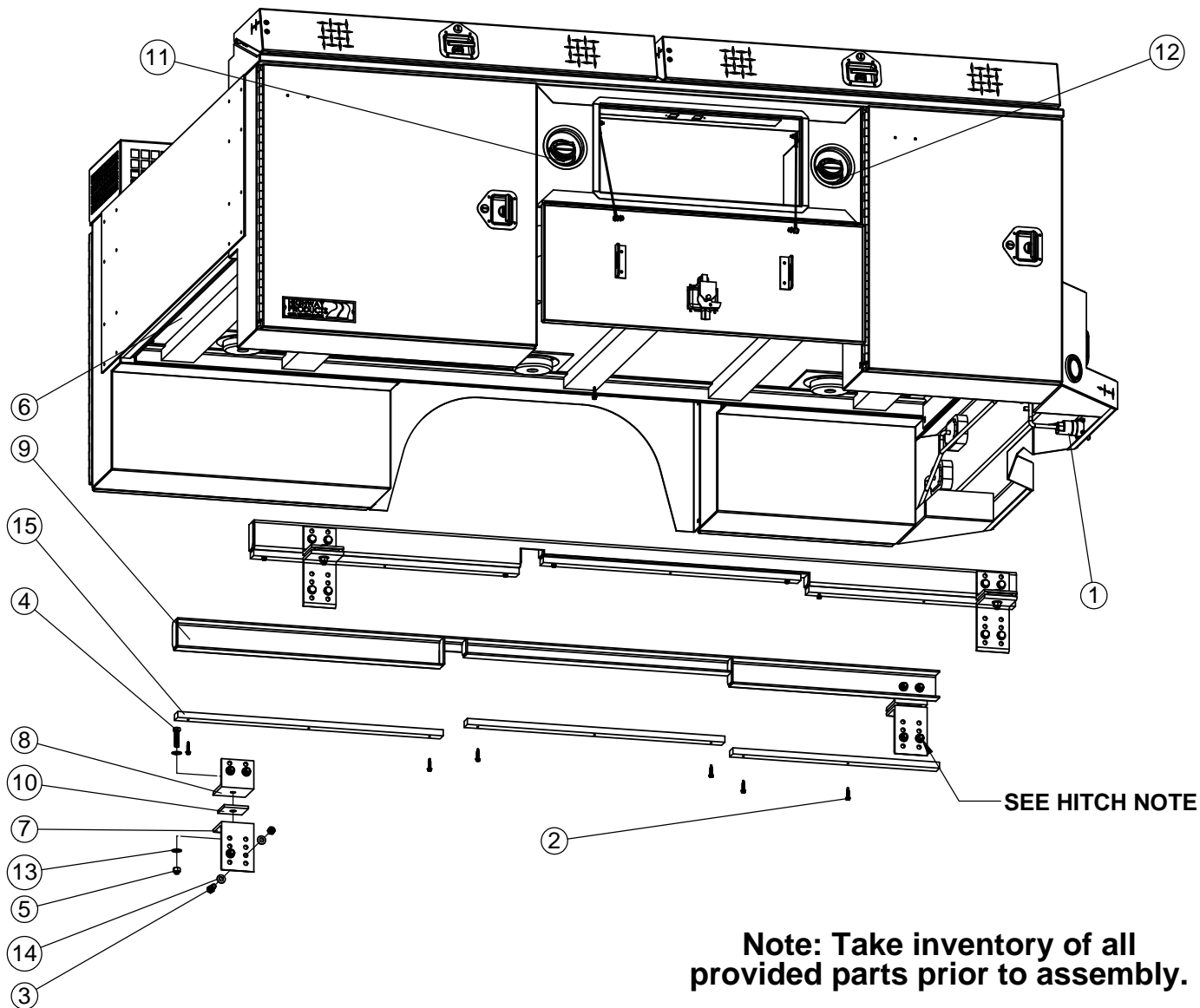

Note: Take inventory of all provided parts prior to assembly.

Provided Parts

ITEM NO.	Desc.	Part #	QTY.	ITEM NO.	Desc.	Part #	QTY.
1	7 Pin Plug Set	020-00011	1	10	Rubber Spacer	-	4
2	1/4"-14x1.25 Self Tap Screw	030-05006	12	11	Service Body Fuel Kit	590-00050	1
3	1/2" x 1-1/2" Hex Bolt	030-15092	16	12	Service Body Urea Kit (for Ford only)	590-00051	1
4	1/2"-13x2" Grade 8 Hex Bolt	030-15016	4	13	5/8" O.D. x.06" Thick Washer	-	8
5	1/2"-13 Top Lock Nut	030-15017	20	14	1" O.D. x .125" Thick Washer	-	32
6	6200 Service Body Assembly	6200 Series	1	15	Wood Spacer Set	740-00004	1
7	Lower Angle Mount	-	4	<p>NOTE FOR OPTIONAL HPI HITCH IF INSTALLED WITH HPI HITCH, USE 5/8" HARDWARE INCLUDED WITH HITCH FOR BACK MOUNT ANGLES TO FRAME.</p>			
8	Upper Angle Mount	-	4				
9	590 Series Frame Mount	590-Series	1				



SECTION 1
BED MOUNT ASSEMBLY

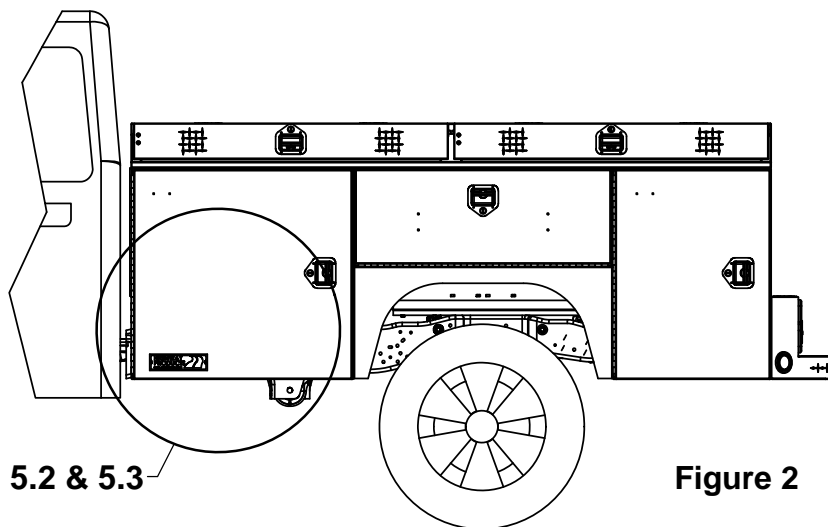

See Figures 5.1, 5.2 & 5.3

Figure 2

Step 1

Fully weld Frame Mount to Cross Members of Service Body as shown in Figures 3, 3.1 & 3.2.

Fasten Wood Spacer Set to Frame Mount as shown in Figures 3.

NOTE: Refer to 590-Series Mount Kit for further installation to frame.

Cross Frame Channel

590 Series Frame Mount

Wood Spacer Set

1/4"-14x1.25 Self Tap Screw

Rear Deck Brace

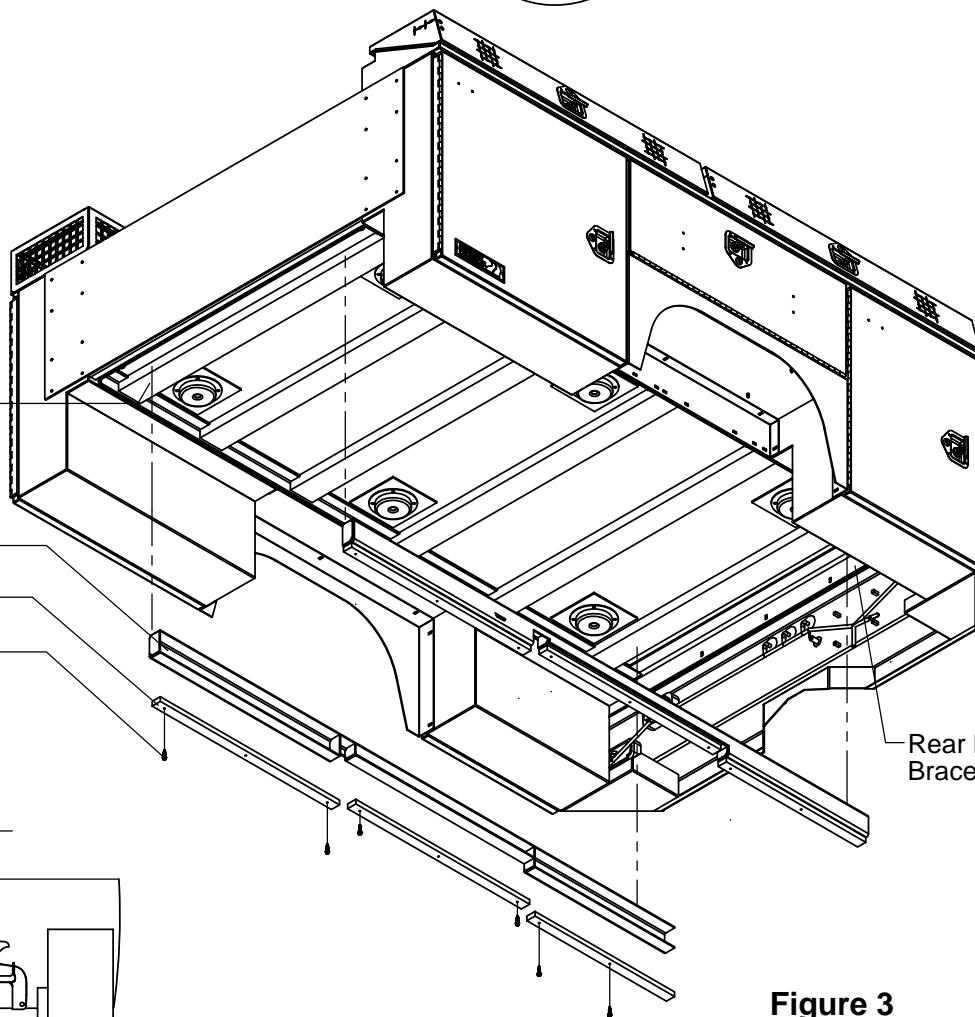

Figure 3

OUTSIDE WIDTH OF FRAME MEASUREMENT

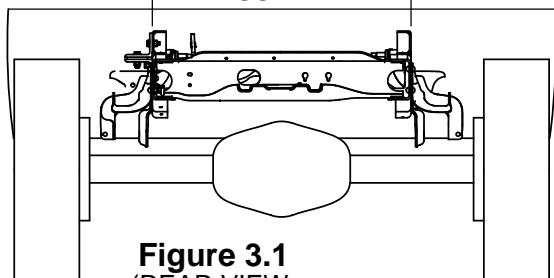

Figure 3.1
(REAR VIEW OF TRUCK)

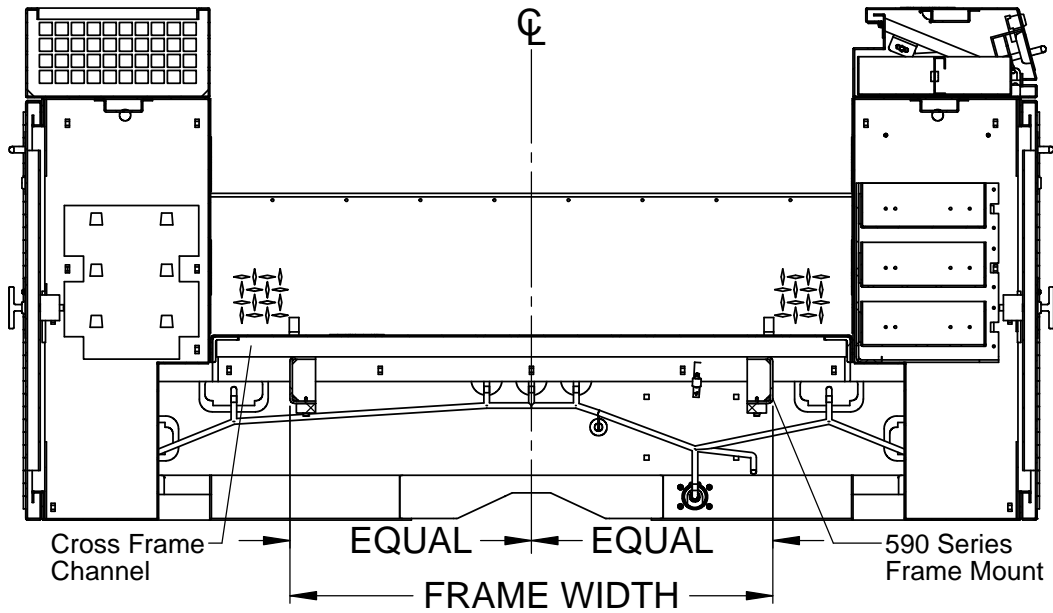

Figure 3.2
(FRONT SECTION VIEW OF TRUCK)

Step 2

Place and align Service Body Assembly on to Truck Frame as shown Figures 4 & 5.

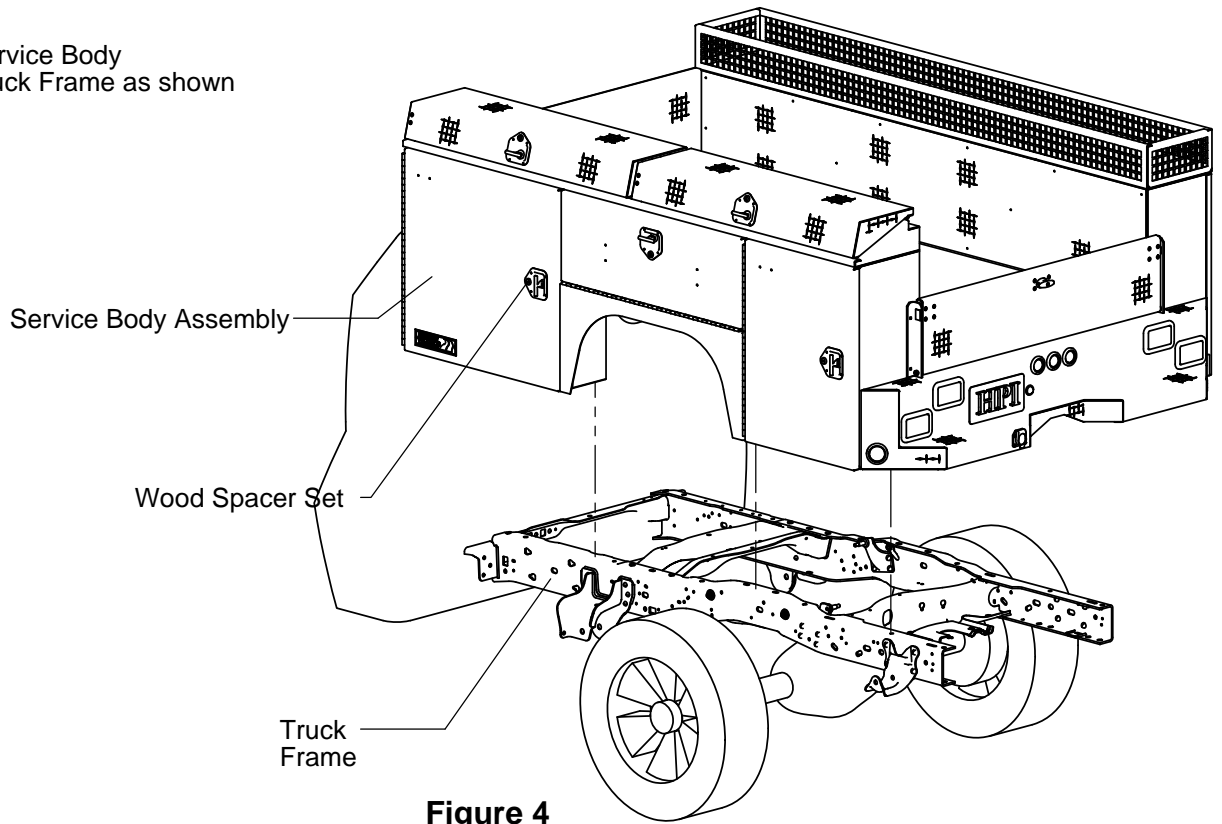
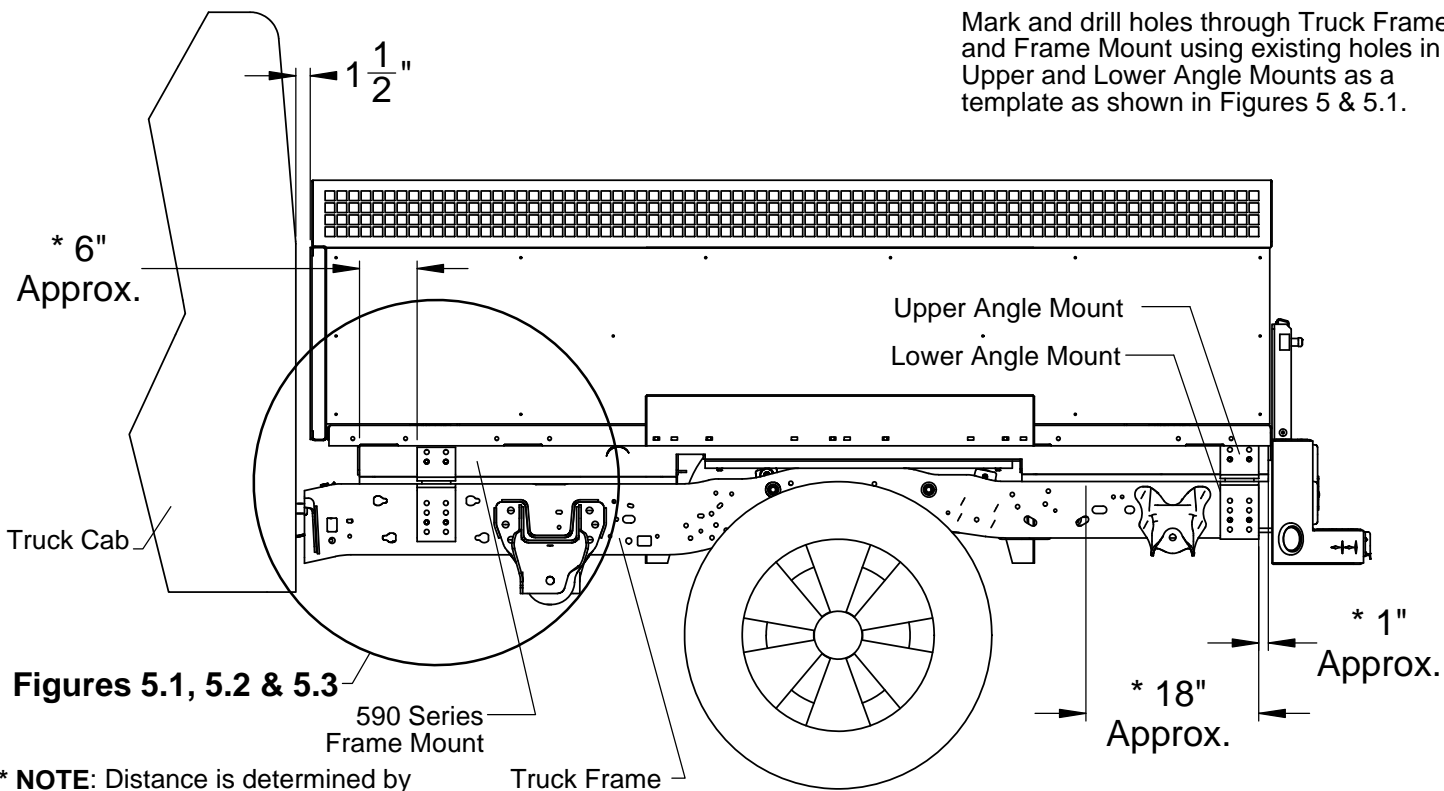

Figure 4



Step 3

Mark and drill holes through Truck Frame and Frame Mount using existing holes in Upper and Lower Angle Mounts as a template as shown in Figures 5 & 5.1.



* NOTE: Distance is determined by existing frame holes and obstructions.

Figure 5

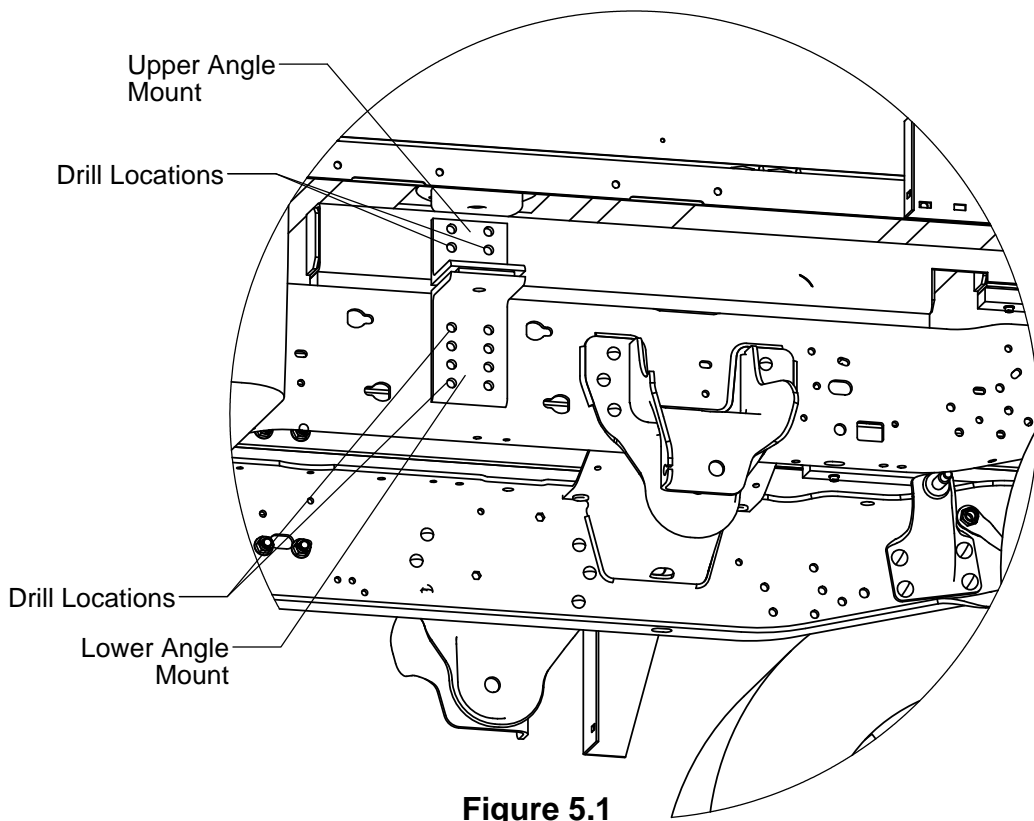

Figure 5.1



Step 4

Fasten Upper Angle Mount to Frame Mount and Lower Angle Mount to Truck Frame using drilled holes as shown in Figure 5.2.

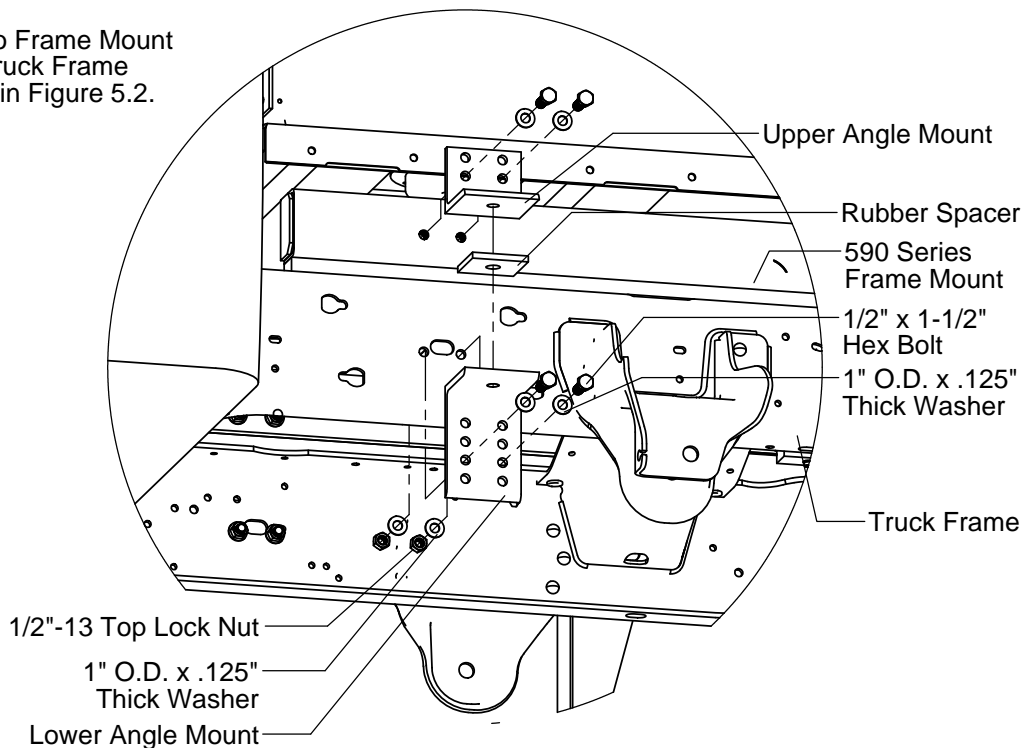

Figure 5.2

Step 5

Fasten Upper Angle Mount to Lower Angle Mount as shown in Figure 5.3.

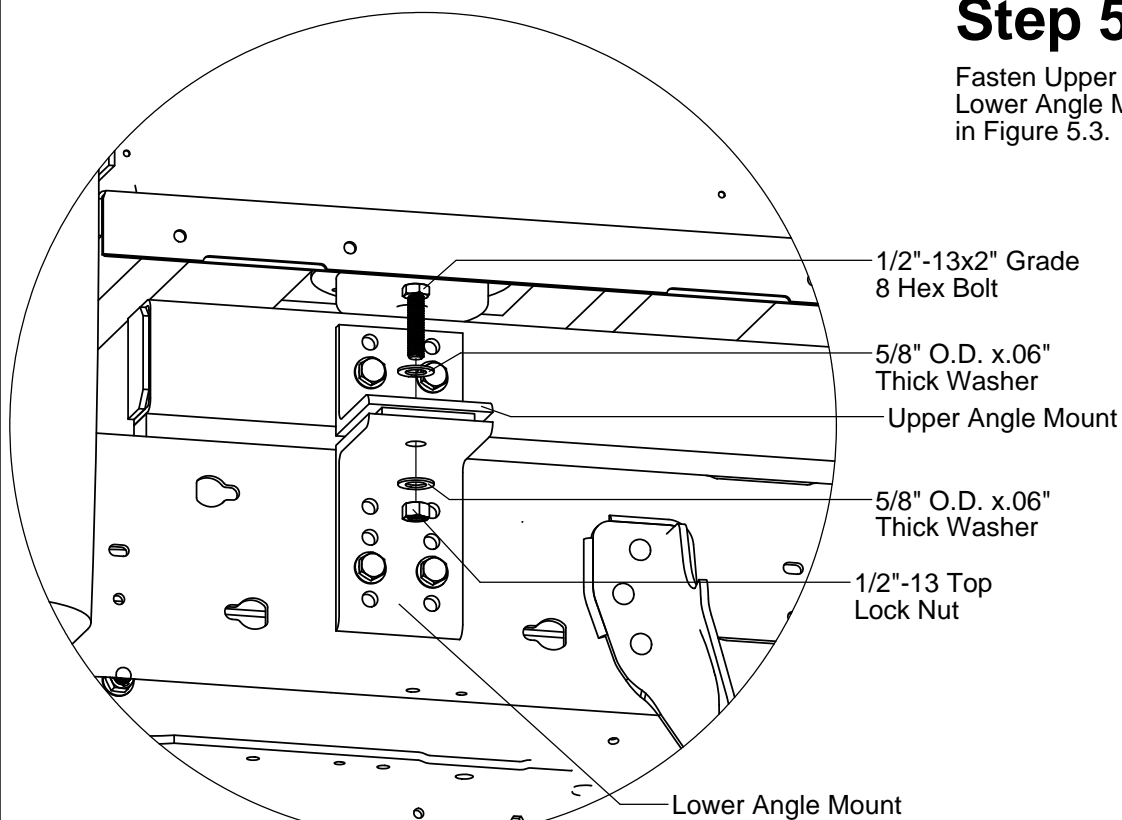

Figure 5.3



SECTION 2
FUEL LINE ASSEMBLY

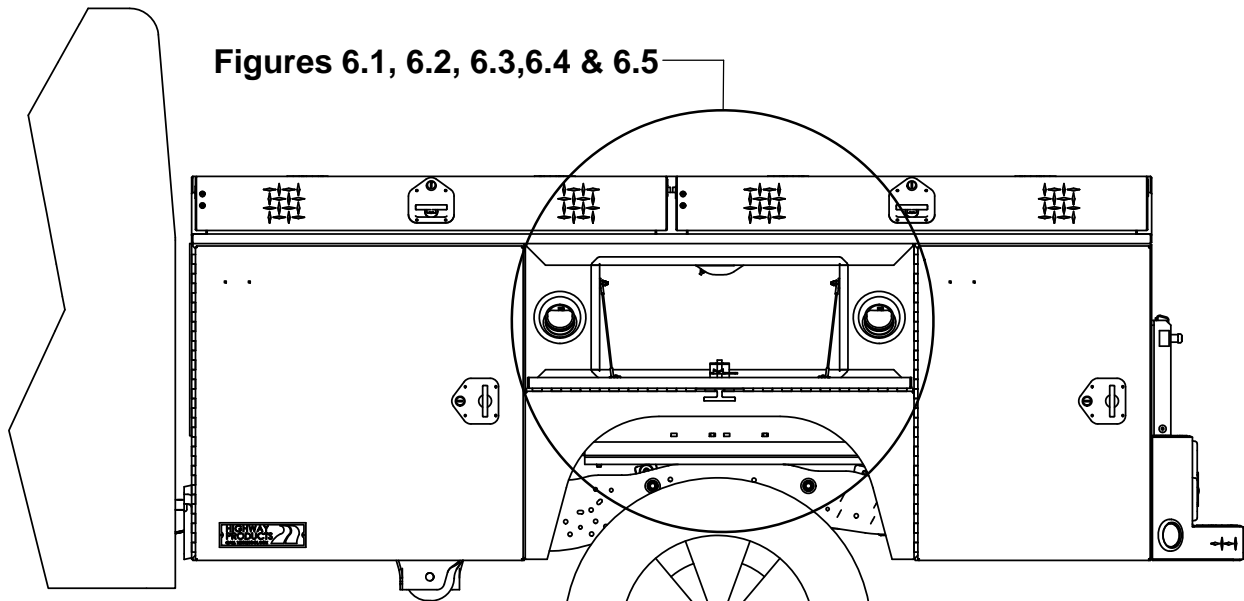

Figure 6

NOTE: Driver Side Fuel Line installation shown. Other configurations will vary slightly, but does not affect assembly.

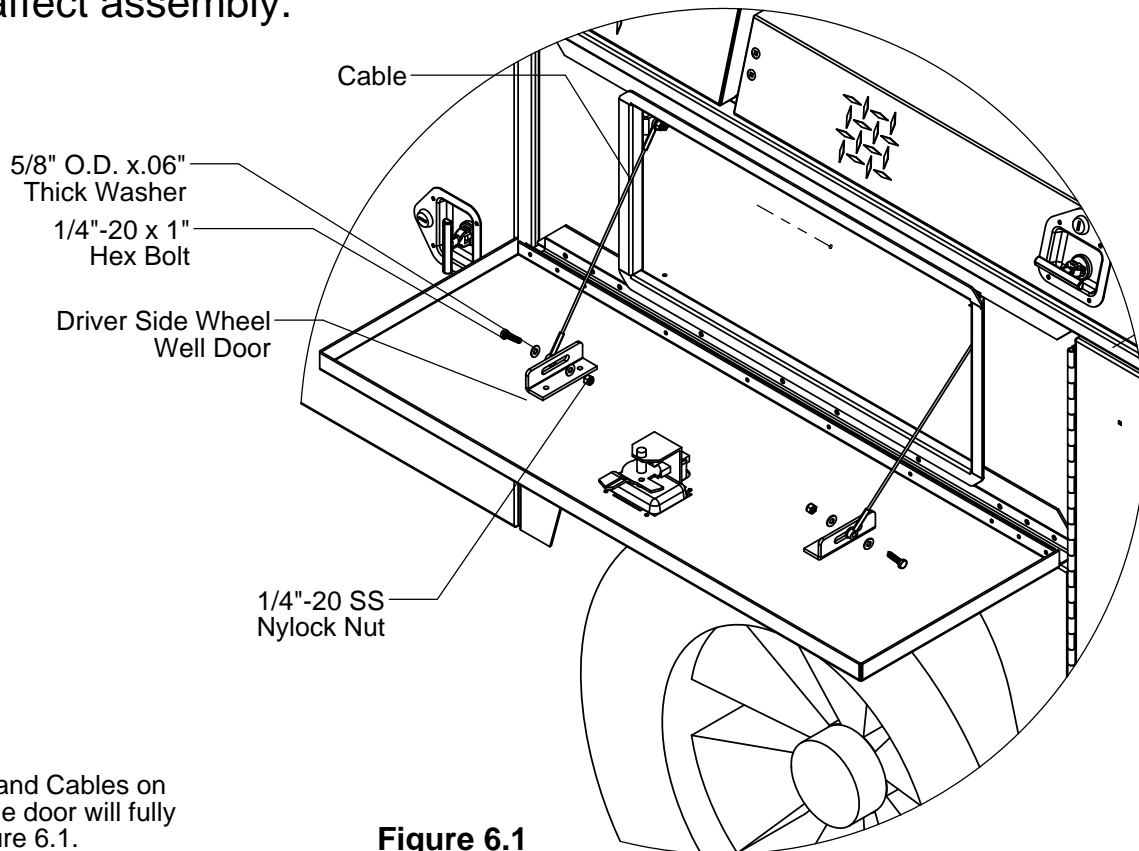

Figure 6.1

Step 6

Disconnect hardware and Cables on Wheel Well Door so the door will fully open as shown in Figure 6.1.



Step 7

Drill holes in Wheel Well Box as shown in Figure 6.2.

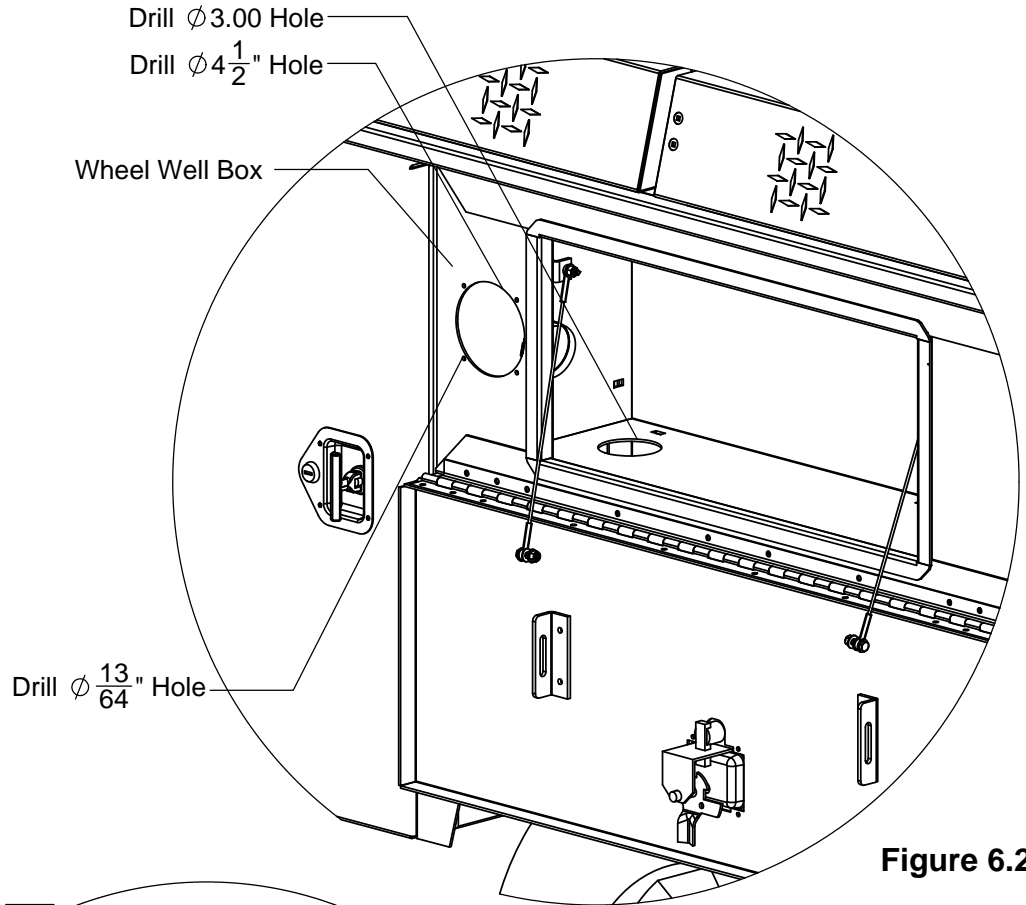

Figure 6.2

Drill aprox. $\phi 2 \frac{3}{8}$ " Hole

590 Series Frame Mount

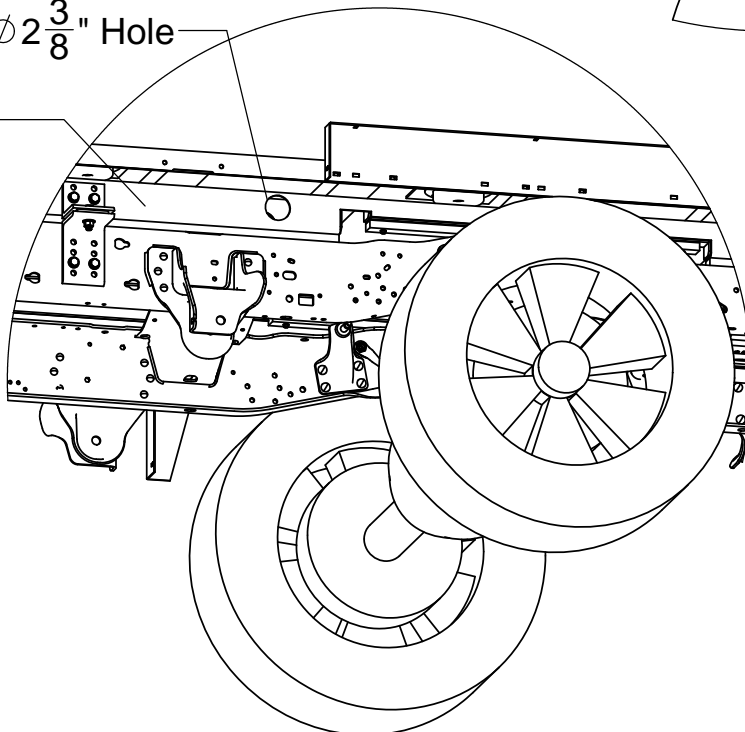

Figure 6.3

Step 8

Drill holes in Frame Mount to allow for fuel line connection to fuel tank as shown in Figure 6.3.

NOTE: Hole placement will be determined by structural obstructions and placement of fuel tank(s).



Step 9

Insert Fuel Line Assembly and Fuel Bezel in Wheel Well Box. Attach Fuel Bezel as shown in Figure 6.4.

Step 10

Cut and remove excess fuel line and attach to fuel tank.

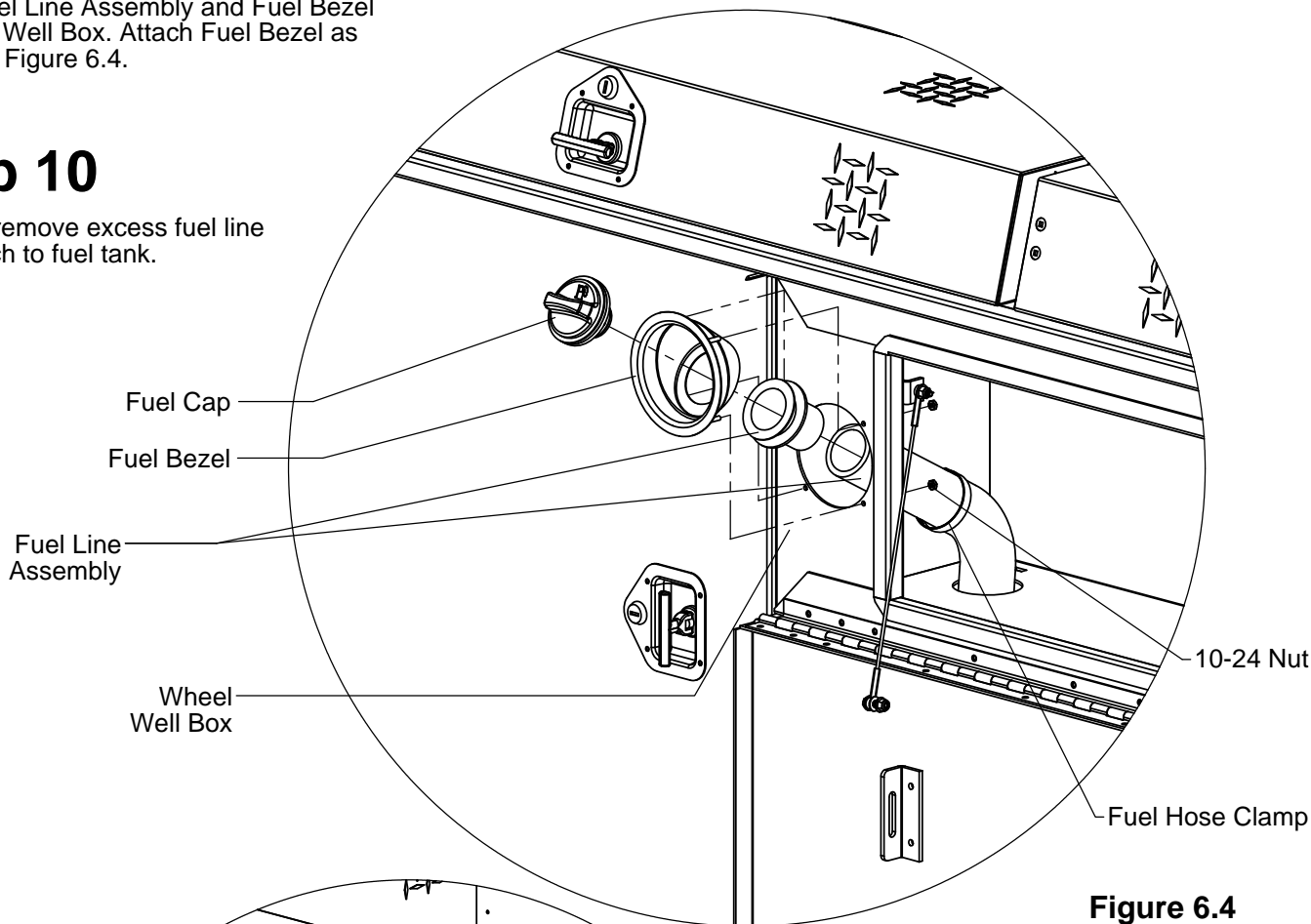

Figure 6.4

Step 11 For Ford Trucks Only

Follow steps 7, 8, 9 & 10 for Urea Fill Bezel installation.

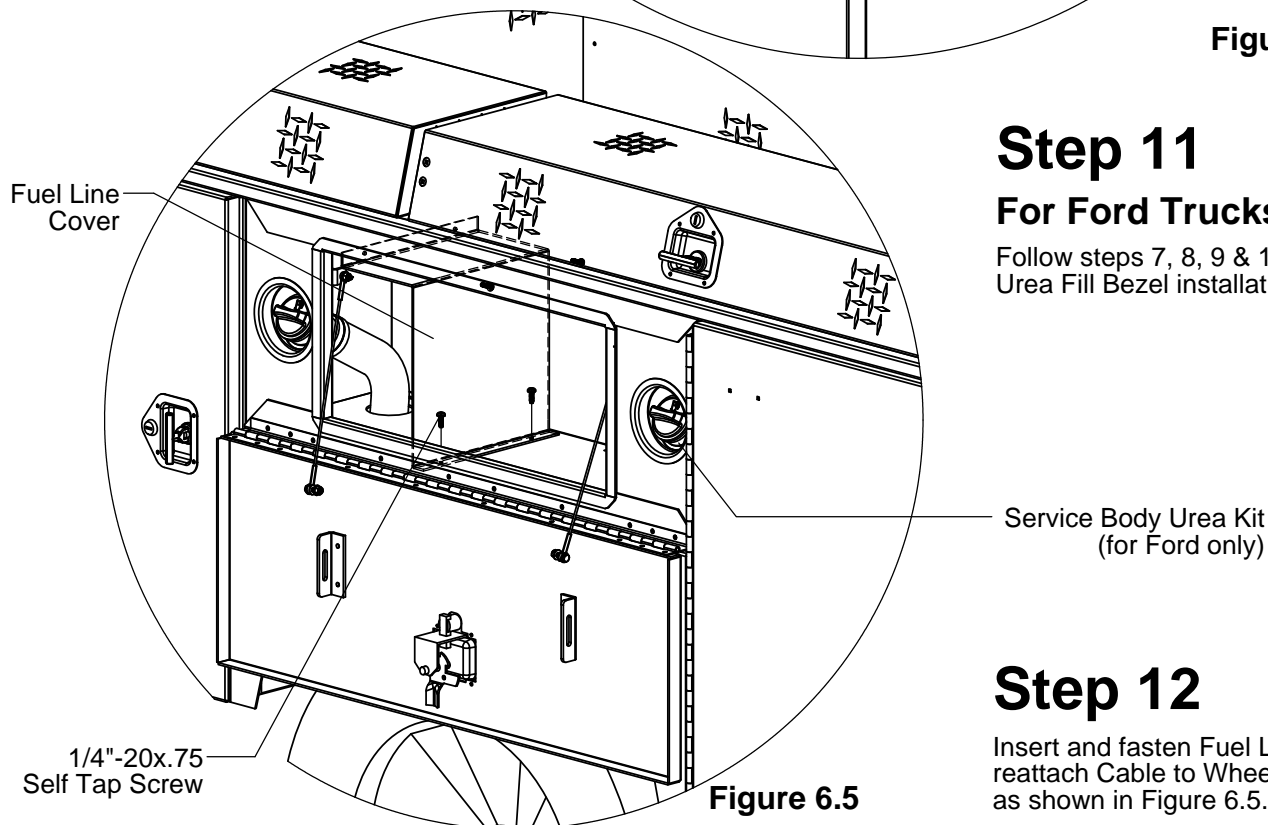

Figure 6.5

Step 12

Insert and fasten Fuel Line Cover and reattach Cable to Wheel Well Door. as shown in Figure 6.5.



SECTION 3
WIRING ASSEMBLY

Note:
See Vehicle's service manual for specific wire harness color code.

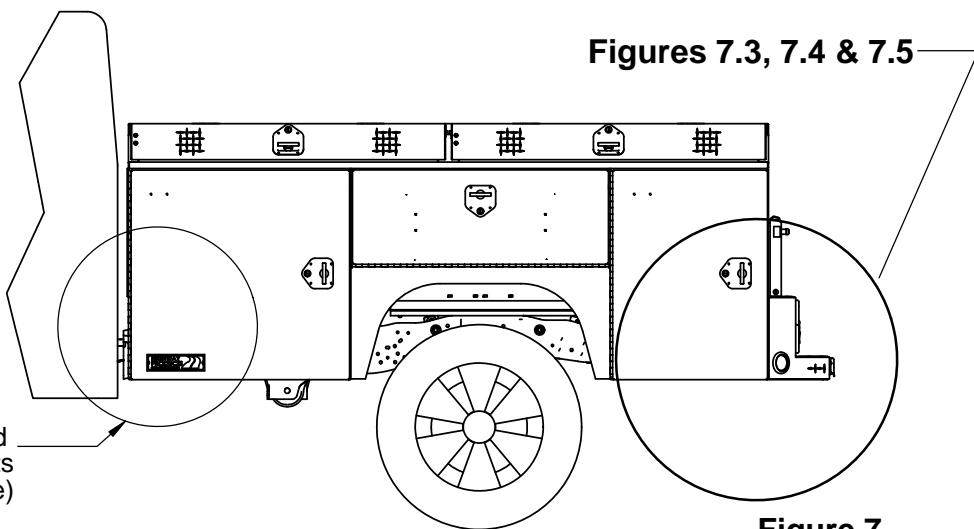

Figure 7

Step 13

Locate and connect Service Body Wire Lead to (+) Battery line.

Step 14

Attach 7 Pin plug and attach wiring to Plug Hub as shown in Figures 7.1 and 7.2.

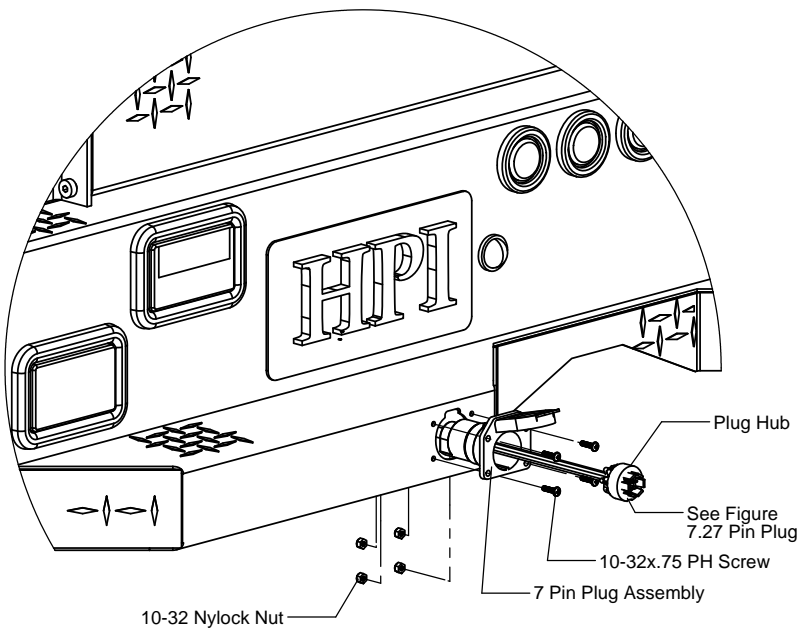

Figure 7.1

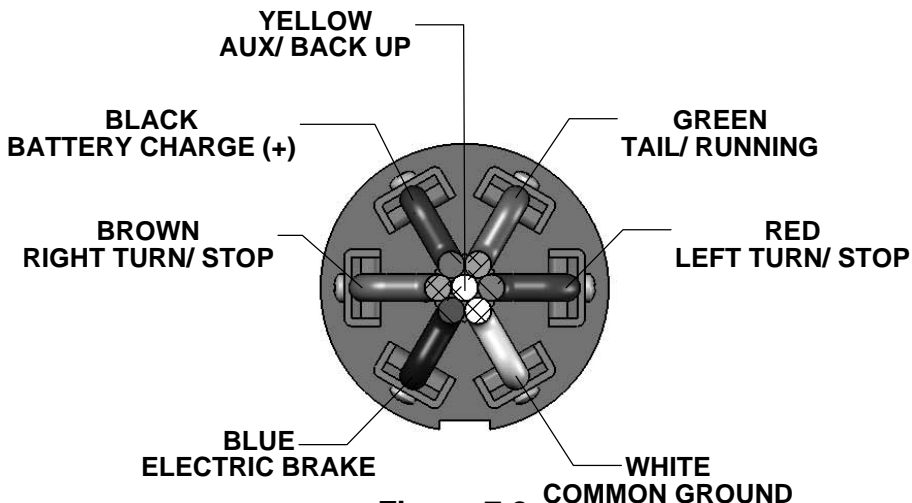

Figure 7.2
HPI 7 PIN COLOR CODE



Step 15

Connect Service Body Wire Harness to Chassis Wire Harness as shown in Figures 7.3, 7.4 and 7.5.

Step 16

Fully tighten all fasteners.

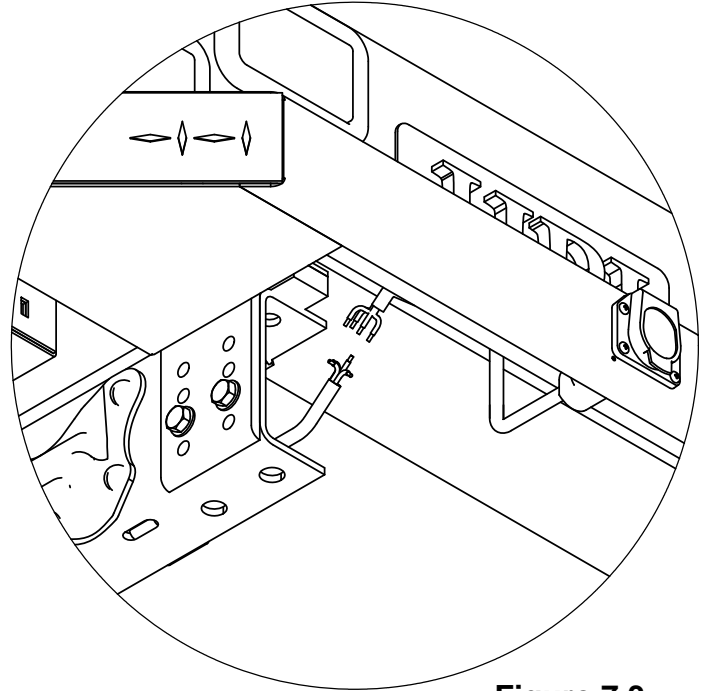

Figure 7.3

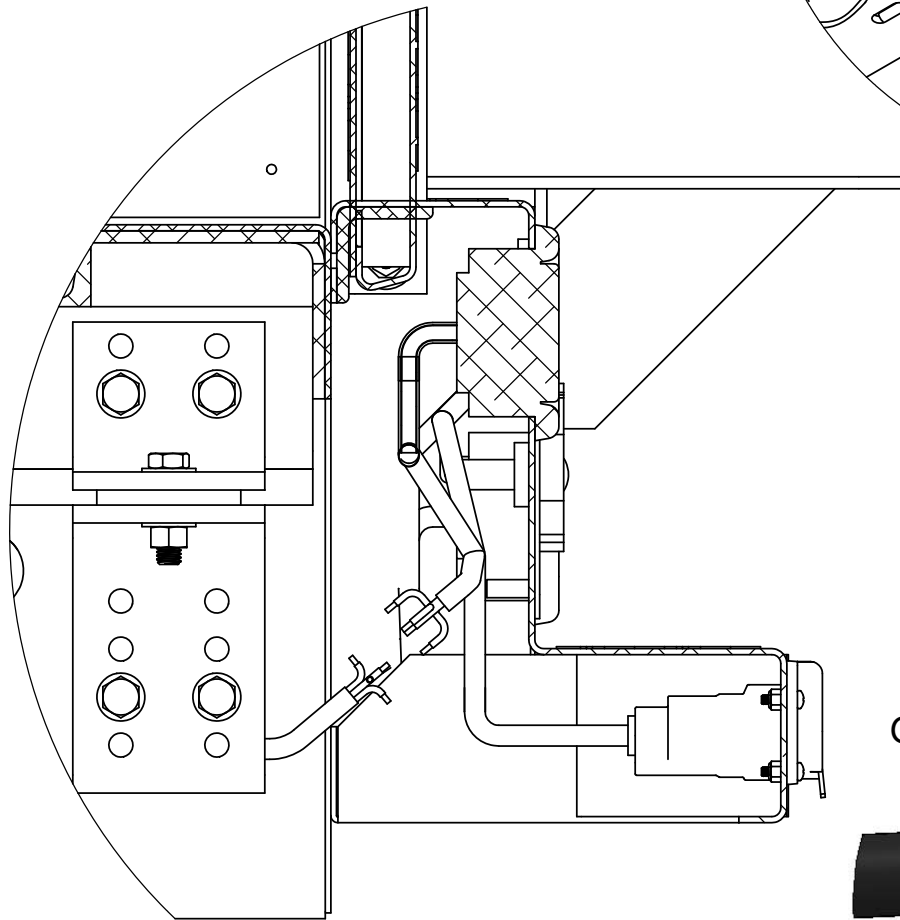

Figure 7.4

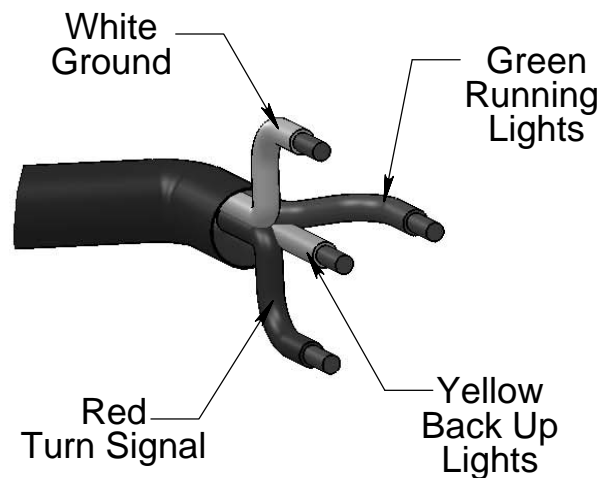

Figure 7.5
HPI TAILBOARD LIGHTING COLOR CODE